

AREAS:	
TOTAL SITE AREA	= 796m <sup>2</sup>
SITE COVERAGE	= 276m <sup>2</sup> = 34.7%
TOTAL FLOOR AREA (OVER FRAMING)	= 264m <sup>2</sup>
TOTAL FLOOR AREA (OVER CLADDING)	= 276m <sup>2</sup>

**NOTES:**

- ALL STUD HEIGHT 2.55m (UNLESS STATED OTHERWISE)
- ALL SOFFIT AND GABLE OVERHANGS NOT DIMENSIONED TO BE 600mm FROM FRAMING.

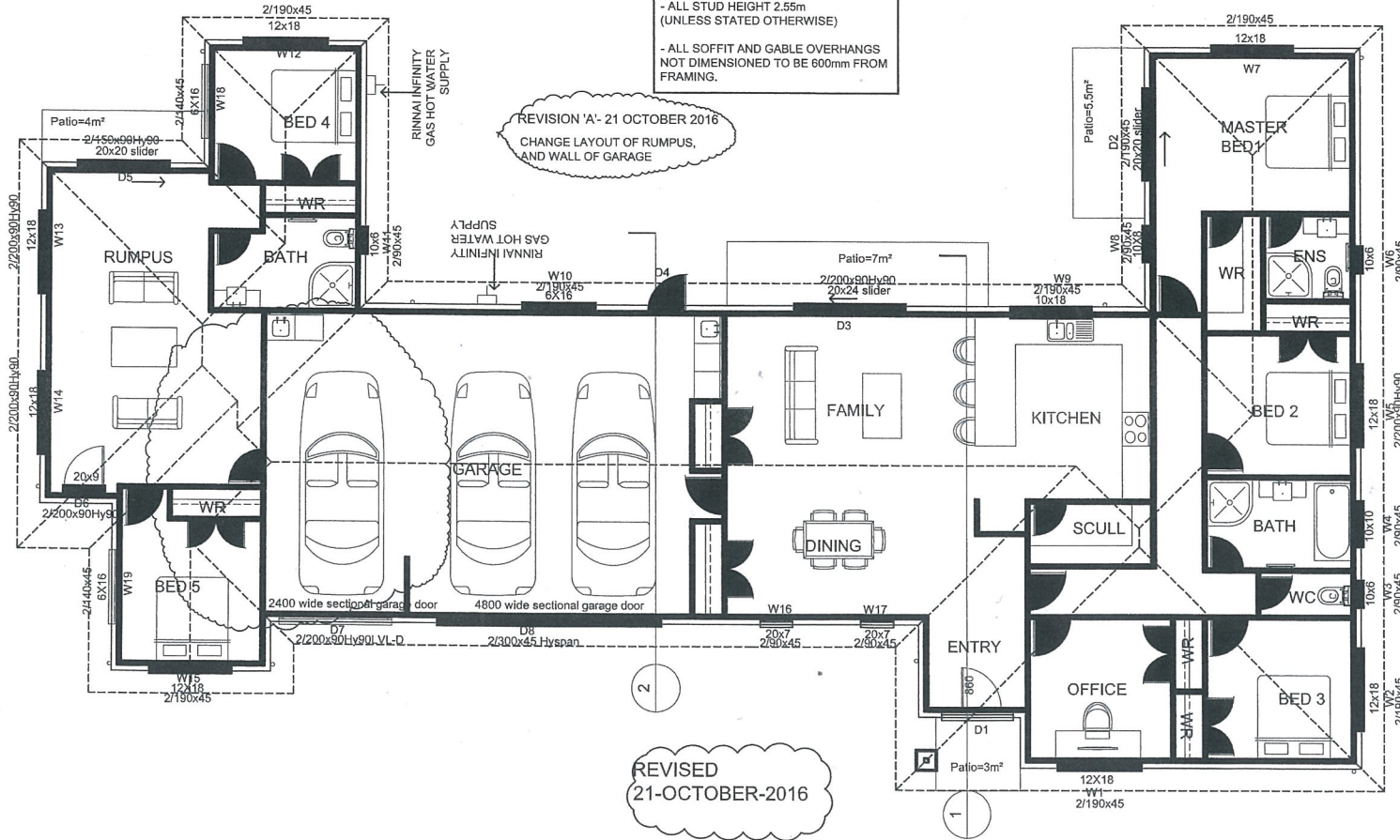

**NOTES:**

- R INSULATION VALUES ARE FLOOR = 2.02 WALLS = 2.01 ROOF = 3.02 GLAZING = 0.26 AS PER ATTACHED H1 COMPLIANCE REPORT
- ALL DIMENSIONS TO BRICKWORK = 120mm
- ALL DIMENSIONS TO FRAMING = 50mm
- ALL STUD HEIGHTS = 2.55m
- ALL SOFFIT AND GABLE OVERHANGS NOT DIMENSIONED TO BE 600mm FROM FRAMING.
- HIGH WIND ZONE Subject to conditions or Building Consent No
- WINDOWS: HEIGHT X WIDTH
- ALL LEVELS TO BE CHECKED ON SITE PRIOR TO COMMENCING CONSTRUCTION.
- CHECK POSITION OF DWELLING WITH OWNER PRIOR TO COMMENCING CONSTRUCTION
- CHECK LINTEL SIZES AND POSITION OF GIRDER TRUSSES WITH APPROVED TRUSS MANUFACTURER.
- ALL FOR LINTEL FIXINGS REFER TO TRUSS LAYOUT DESIGN SPECIFICATION SHEET NO.2- FOR BUILDING CONSENT LINTEL FIXING AND LUMBERLOK LINTEL FIXING SCHEDULE
- TRUSS TO TOP PLATE TO BE FIXED WITH TYPE C-2/90X 3.15 SKEWED NAILS+2 WIRE DOGS AS PER NZS3604:2011 TABLE 10.14.
- 10mm GIB AQUALINE WALL LINING TO ALL WET AREAS INCLUDING LAUNDRY

**TIMBER TREATMENTS:**

ALL TIMBERS ARE SG B, UNLESS STATED OTHERWISE

ALL TIMBERS ARE H1.2 TREATED AS PER TABLE 1A B2/AS1, EXCEPT:

- DRAINAGE CAVITY BATTENS ARE H3.1
- ANY EXPOSED OR CANTILEVERED MEMBERS ARE H3.2
- ANY POSTS OR PILES IN CONTACT WITH THE GROUND ARE H5.

Approved Waipa District Council Building Department  
 16

<b>InTop Homes</b> 55 London Street, Hamilton Centre E-mail: suyin331@gmail.com Ph: 07-8380829	<b>Project:</b> LOT 2 THORNTON PARK CAMBRIDGE	<b>Drawing Name:</b> FLOOR PLAN	<b>Amendments:</b>	<b>Scale:</b> 1:100	<b>Drawing NO:</b> 3A
				<b>Date:</b> 21/10/2016	