

UNIT 30/7 TUNNEL GROVE, SEAVIEW, WELLINGTON



View on
Google Maps



Comprendé



Ready Now - Invest or Occupy!

Experience a world of opportunities at The Quarter - an exceptional development that caters to various needs and ventures. Complete with carpark and electric roller door, this 17m² unit offers 5.2m high stud, and the flexibility of multi-use, whether you're an aspiring entrepreneur, seeking a secure investment, or just looking for a contemporary space to store your prized possessions, this remarkable new venture offers it all.

Nestled in the vibrant heart of Wellington's thriving industrial and commercial hub, The Quarter is poised to become a dynamic and lively precinct. Get ready to witness a captivating mix of bustling trade showrooms and small businesses, all coming together to create a thriving and energetic atmosphere.

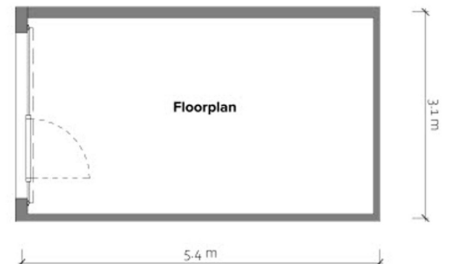

30% Trade : **NZ\$131,600 (Cash) | NZ\$56,400 (Trade)**

\$188,000.00 + GST

Contact Grant Foggo for further enquiries: 027 548 2047



bartercard